

OCHRE

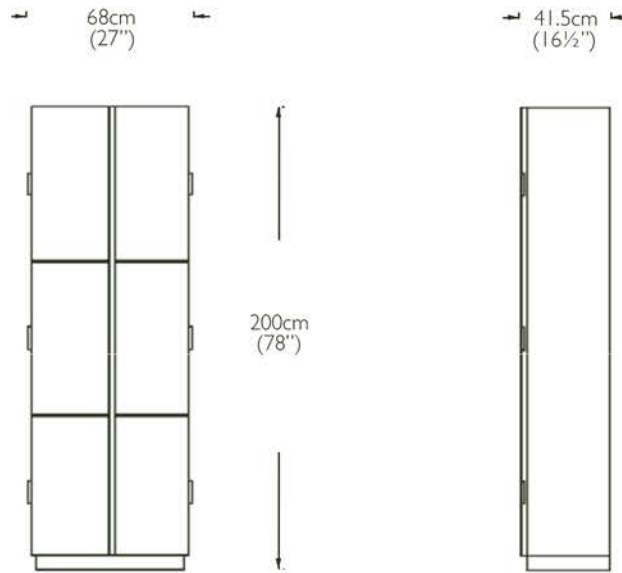

colours shown are a general indication of the actual finish  
b-l-a-c-k-e-n-e-d  
s-t-e-e-l  
f-r-a-m-e  
l-e-a-t-h-e-r  
f-r-o-n-t  
p-a-n-e-l



dimensions:

external - 68cm w x 41.5cm d x 200cm h (27" w x 16½" d x 78" h)  
internal - 60cm w x 33cm d x 190cm h (23½" w x 13" d x 74¾" h)  
with 5 adjustable steel shelves

weight:

approx 130kg (300lbs)

lead time:

10 - 12 weeks

custom sizes available - please enquire

leather colour can vary from hide to hide and will change naturally over time based on use and exposure to sunlight • hides are selected from the finest leathers with natural variations in colour, veining, marks and scars • such characteristics should therefore not be considered as faults • this is a natural, unfinished leather which has a silky soft feel and should be treated with care as it can bruise if it comes into contact with hard or sharp objects

## leather and steel cupboard

two door blackened steel cupboard with leather wrapped front panels and matt black interior