

# ADAM OTLEWSKI



## UNTITLED SIDE TABLE 3.0 (TRIANGULAR)

Solid machined brass with oval head slotted screws.. The triangular design is completely reversible, being fully finished on top and bottom allowing the table to be flipped to whichever side is necessary.

20"H x 19"D x 11-3/4" W

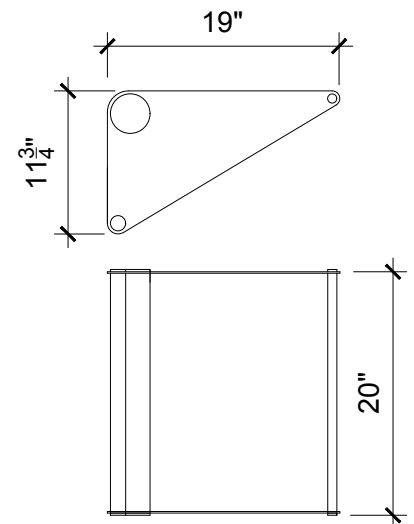

All material finishes are living finishes: they will change and patina for the better with time and use. Every product is individually hand-made to order and slotted in frequent production batches; lead time is determined once order is confirmed.